

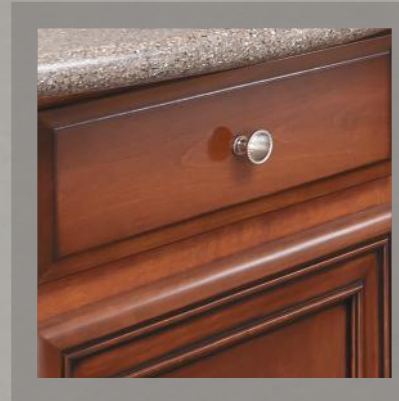

2014  
**BAY STAR  
& BAY STAR SPORT**  
*Gas Motor Coach*



NEWMAR • 2014 BAY STAR  
2014 BAY STAR SPORT



WHEN YOU KNOW THE DIFFERENCE <sup>SM</sup>

# 2014 Bay Star Sport



**2014 Bay Star Sport Exterior**

*Floor plan #3220 in Onyx Exterior with Optional Paint*



## The life you deserve, at the price you desire.

The 2014 Bay Star Sport brings all the quality and comfort that you expect from Newmar. Whether you're a motor coach weekender looking to move up to the next level, or you're entirely new to life on the road, the Bay Star Sport will satisfy your wanderlust in style.

## Beauty, redefined.

The 2014 Bay Star Sport exterior graphics are all new. The Bay Star Sport offers four distinct exterior décor options and the Newmar commitment to a superior quality finish ensures you won't believe your eyes.



### ***Features at a glance:***

- Six-way power driver's seat\*
- Lighted exterior storage compartments with cargo liner
- Driver/passenger overhead dash fans with 13.5M Brisk® Central Air Conditioner

\*Optional



**Bay Star Sport Interior**

*Floor plan #3220 with Carbon Décor Style and Bisque Maple Cabinetry with Glazed Doors*

# Splendor from the outside in.

When you step inside the Bay Star Sport, the wonder doesn't end. Every inch of the coach's interior is flawlessly crafted, from the sharp contrasting welt on the plush leather sofa to the new diagonally-laid vinyl flooring to the Flexsteel furnishings. The Bay Star Sport's interior is designed to impress from ceiling to floor.

In the Bay Star Sport, the ambitious cook will have everything necessary to prepare any meal, no matter where you go. Every part is designed to perfectly bond functional craftsmanship with bold style. Spacious countertops, a new "woven grass" backsplash, and intricately constructed cabinetry all set the Bay Star Sport apart.

## ***Features at a glance:***

- Three-burner range with metal oven door & Piezo Ignition
- Norcold® 8 cu. ft. refrigerator with black front panel
- 30" Over the range microwave oven (on floor plan #3220)

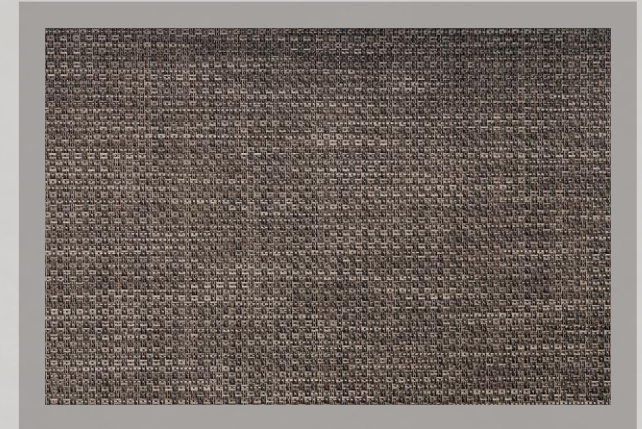

# Sleep ensconced in rich comfort.

The attention to detail in décor and design doesn't stop in Bay Star Sport's main cabin. A slew of new amenities make the bedroom something special, whether you're going straight to sleep after a day on the road, or you want to watch a bit of television before drifting off. The scalloped plush headboard with braided cord inlay adds class, and the all-new window treatments feature enhanced styling – along with the new quilted bedspread and dressings.

A pair of full-size mirrors expand the room, and ample storage space means you can bring as much of your wardrobe as you like. From the high quality fabrics to the carefully-designed color palettes, Bay Star Sport's bedroom is built for comfort and style.

## ***Features at a glance:***

- Smooth-top mattress with lifts on bed top
- Sony® LED TV and DVD player
- Quilted bedspread with shams, bed scarf, and accent pillow





## Refresh yourself at your leisure.

Bay Star Sport's bathroom affords you the space and features you need to keep comfortable on the road, wherever it takes you. Ample storage, as well as a large shower, sink, and countertop all give your family the room it needs while getting ready for your day. Add in the trademark Newmar décor and design, and touches like the natural light from the shower skylight, and the Bay Star Sport bathroom impresses visually and functionally.

## BAYSTAR SPORT EXTERIOR DÉCOR



Onyx Exterior/Optional Paint

## BAYSTAR SPORT INTERIOR DÉCOR

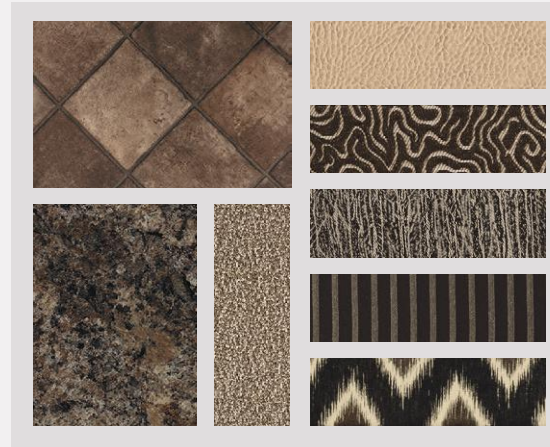

Carbon Interior

## WOOD OPTIONS



Empire Maple with Glazed Doors



Bisque Maple with Glazed Doors



Sahara Exterior/Optional Paint

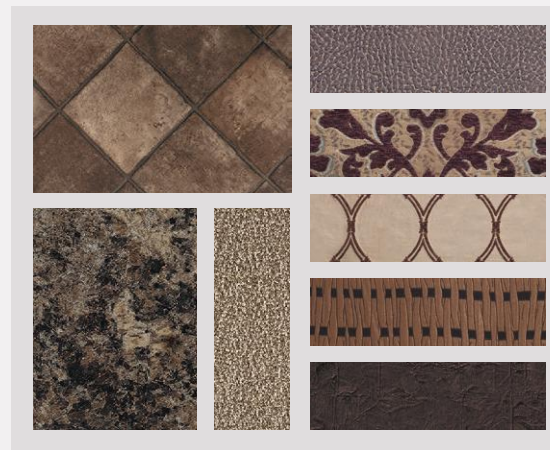

Coffee Interior



Sienna Maple with Glazed Doors



## BAY STAR SPORT FLOOR PLANS

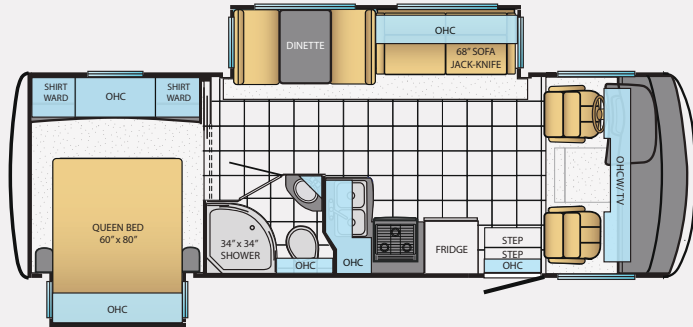

2702

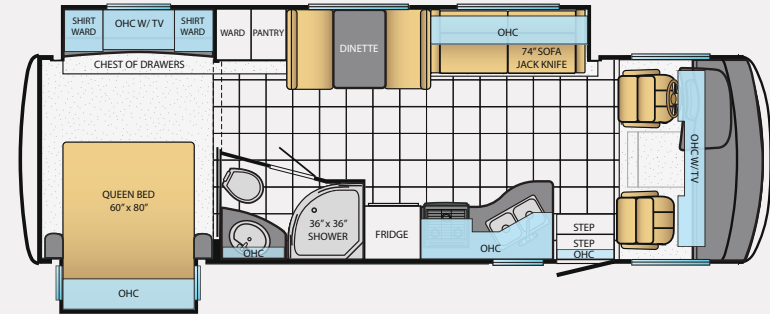

2903

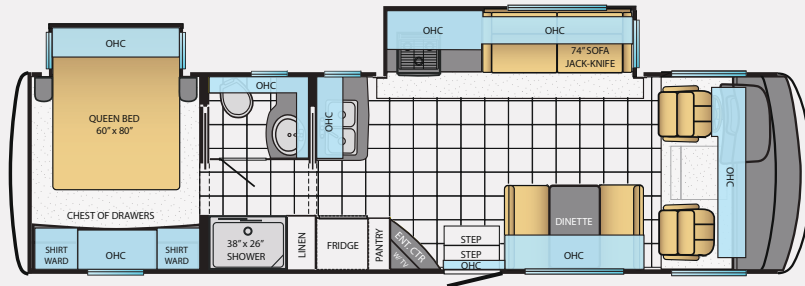

3220

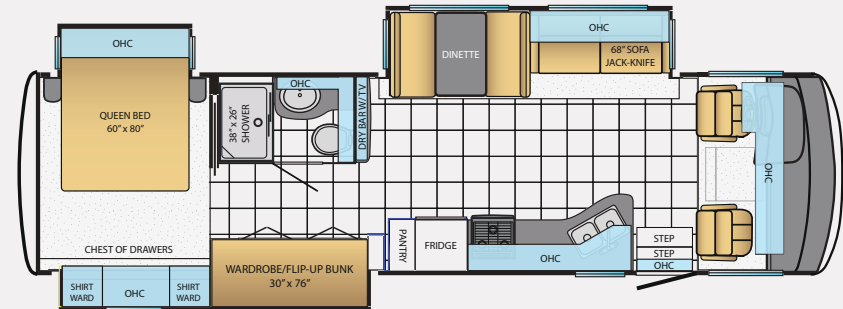

3306

## FLOOR PLAN SPECIFICATIONS

Floor Plan	App. Overall Length	Width	App. Overall Height	Interior Width	Interior Height	Grey Tank	Sewage Tank	Water Tank	Propane Tank	Furnace
2702	27' 10"	101.5"	12' 4"	95.5"	80"	60 gal.	40 gal.	75 gal.	25 gal.	30,000 btu
2903	29' 10"	101.5"	12' 4"	95.5"	80"	60 gal.	40 gal.	75 gal.	25 gal.	30,000 btu
3220	32' 11"	101.5"	12' 4"	95.5"	80"	60 gal.	40 gal.	75 gal.	25 gal.	30,000 btu
3306	33' 11"	101.5"	12' 4"	95.5"	80"	60 gal.	40 gal.	75 gal.	25 gal.	30,000 btu

# BAY STAR SPORT FEATURES & OPTIONS



## Chassis Features

*Built specifically for Newmar with the highest quality in handling, safety, performance, and dependability.*

Ford F-53 Chassis 18,000 lb. on 2702 & 2901 floorplans

Ford F-53 Chassis 20,500 lb. on 3209 & 3310 floorplans

Cruise Control

Tilt Steering Wheel

Stainless Steel Wheel Simulators



## Air Conditioning & Heating

*Total Comfort Air Conditioning and Heating systems make climate control simple and effective.*

13.5M Brisk® Central Air Conditioner

Dash Heater and Air Conditioner

Propane Gas Furnace with Ducted Heat

Propane Leak Detector

### OPTIONS

15.0M Penguin™ Heat Pump Central Air Conditioner

Auxiliary Heater in Bedroom

Extra 13.5 Brisk Air Conditioner, 5.5 Onan Generator, 50 Amp Electrical Service with Energy Management System



## Appliances & Accessories

*All of the amenities of a fine home are integrated in the Newmar design, in both form and capabilities.*

Three-Burner Range with Glass Oven Door

Range Hood with Light and Fan

Dometic® 6 Cu. Ft. Refrigerator with Wood Paneling Front

Microwave Oven

6 gal. Gas/Electric Water Heater with Direct Spark Ignition



## Audio, Video & Accessories

*Stay entertained on the road and off, with spectacular visual and sound options from industry leaders.*

LED TV in Living Area (TV sizes vary per floorplan)

AM/FM Dash Radio with CD Player and Auxiliary Jack

Rearview Colored Monitor System with Audio

Winegard Digital TV Antenna

### OPTIONS

LED TV in Bedroom

DVD Player with Coax Switcher

Satellite Dish Prep on Roof

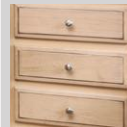

## Cabinets & Furniture

*Amish craftsmanship and elegance in design meld the wood cabinetry and furniture seamlessly with the Newmar interior.*

Sienna Maple Mitered Designer Glazed Cabinet Doors

Empire Maple Mitered Designer Glazed Cabinet Doors

Concealed Hinges on Cabinet Doors

Laminate Kitchen Countertop with Stainless Steel Sink

Laminate Countertop on Bedroom Nightstands and Chests

Laminate Countertop in Bathroom with Acrylic Sink

Residential-Style Full-Extension Ball Bearing Drawer Guides

Flexsteel® Delux Leather Furniture

Lifts on Bed Top

Smooth-Top Mattress

### OPTIONS

Bisque Maple Glazed Cabinets

Plush Pillow Top Mattress

Fold & Tumble Sofa with Air Mattress

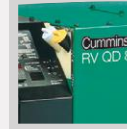

## Electrical Features

*A Newmar coach's electrical and lighting system is designed for maximum reliability, functionality, and style.*

4.0 kW Cummins Onan® Generator with Remote Switch and Automatic Changeover

30 Amp Electrical Service with Flexible Cord

Two 12 Volt House Batteries

Manual Battery Disconnect Switch

110 Volt Exterior Receptacle

12 Volt Auxiliary Receptacle on Dashboard

45 Amp Converter

Daytime Running Lights

Emergency Start Switch

Incandescent Ceiling Lights Throughout

Manually Operated Hold-To-Run Slideout Switch

Cable TV Connection

### OPTIONS

600 Watt Inverter for Living Area and Bedroom TVs



## Exterior Features

*The Full-Paint Masterpiece Finish is one of the most beautiful and durable in the industry, with the goal of a perfect finish, every time.*

Exterior Vinyl Graphics on White Exterior

---

Lighted Exterior Storage Compartments with Cargo Liner

---

Automatic Step for Entrance Door

---

Convex Exterior Mirrors

---

Lighted Exterior Storage Compartments Finished with Cargo Liner

---

Rear Hitch for Towing Car

---

Assist Handle at Entrance Door

---

Undercoating

---

Mud Flaps

### OPTIONS

Convex Exterior Mirrors with Defrost and Remote Control

---

Hydraulic Leveling Jacks

---

Rear Ladder

---

Diamond Shield Protection on Front Cap

---

Exterior Painted Skirt and Mask

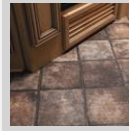

## Interior Features

*Flooring – both tile and carpet – is installed with Newmar's own in-house process, ensuring the best in quality and longevity, as well as the finest fit.*

Vinyl Ceiling Panels

---

Pleated Window Shades

---

Decorative Wall Art

---

Mini Blinds in Bathroom Window

---

Vinyl Floor in Kitchen, Living Area and Bathroom

---

Carpeting on Slideout floors

---

Interior Assist Handle at Main Entrance Door

---

Quilted Bedspread with Shams, Bed Scarf & Accent Pillows

---

Inlaid Six Panel Design Interior Passenger Doors

---

Auto Motion Power Shade at Windshield & Manual Shades at Driver & Passenger Side Windows

---

Dash Panel color Coordinated ABS

---

10 Bc Fire Extinguisher, Smoke Detector and Carbon Monoxide Detector



## Windows, Vents & Awnings

*Experience as much – or as little – of the outdoors as you want in comfort and style.*

One Piece Bonded Tinted Windshield

---

Single Pane Tinted Safety-Glass Windows

---

Power Vent in Bathroom

---

Skylight in Bathroom\*

---

Dometic® 8500 Side Awning

### OPTIONS

Two Slideout Covers

---

Double-Pane Tinted Safety Glass Windows

---

Dometic® 9100 Side Awning

---

Rear Window in Bedroom

---

Power Vent in Kitchen

---

Bunk Windows\*

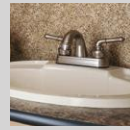

## Plumbing & Bath Features

*The Demand Water System's residential flow response ensures that the comfort and reliability of home are never far away.*

Demand Water System

---

Sewage Holding-Tank Rinse

---

Water Heater Bypass System

---

Dometic® China Bowl Stool

---

ABS Shower Surround with Shower Door

---

Monitor Panel

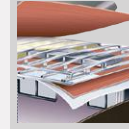

## Construction Features

*From the chassis on up, Newmar coaches are built to be dependable, durable, comfortable, and beautiful.*

BriteTEK™ Roof with Walkable Decking

---

Gelcoated Fiberglass Exterior Sidewalls, Front & Rear Caps

---

Aluminum-Frame Sidewalls & Roof on 16" Centers

---

5/8" Foam Insulation Laminated in Sidewalls & Ceiling

\*Check with dealership on floor plan availability and complete listing of features.

# 2014 Bay Star



**2014 Bay Star Exterior**  
*Floor plan #3124 in Latté Exterior*



## The 2014 Bay Star.

The gas-powered Bay Star has all the elegance and class you expect and demand from Newmar, but for a price suited for new RVers, or seasoned travelers. Declare your independence – and lose nothing.

Bay Star comes with the Newmar Full-Paint Masterpiece™ Finish, which provides a rich and vibrant look that will turn heads on the road and on the campground. Newmar paints every Bay Star so be rest assured that the intricate, four-color design is of the highest quality and will stand the test of time.



### *Features at a glance:*

- Cruise control, tilt steering wheel, and optional six-way power driver's seat
- Lighted exterior storage compartments with cargo liner
- 13.5M Brisk® Central Air Conditioner, and propane gas furnace with ducted heat



**Bay Star Interior**

*Floor plan #3124 with Inca Tan Décor Style  
and Empire Maple Cabinetry*

# So alluring, you won't want to go back home.

Beautiful woodwork. Fine furniture. Sparkling fixtures. When you step inside the Bay Star, you'll never want to leave. Optional vinyl tile flooring, lighted wall sconces and artwork bring the whole room together. From the two-tone braided welt on the couch to the all-new fascia, Bay Star truly is your home away from home.

The Bay Star kitchen is extremely well-appointed to meet any culinary experience. Optional solid surface counters and the standard routed solid surface backsplash with metallic glass inserts merge form with function to make your kitchen attractive and practical.

## ***Features at a glance:***

- Empire Maple mitered designer glazed cabinet doors
- Three-burner range with metal oven door & Piezo Ignition
- Norcold® 8 cu. ft. refrigerator with black front panel
- 30" Over the range microwave oven

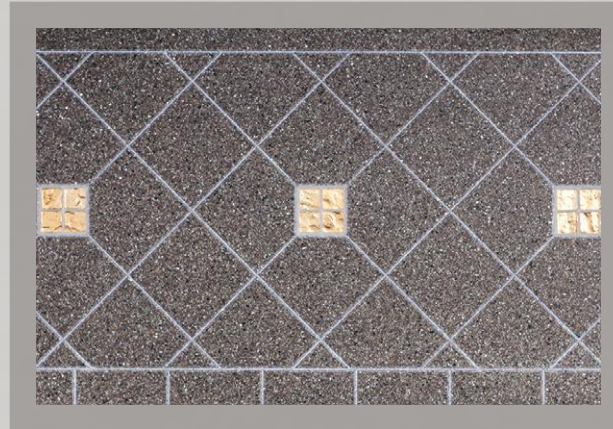

# End your day in style and comfort.

The Bay Star's bedroom will make you forget you're not at home. New wainscoting in the rear wall, integrated ceiling and overhead lighting, wood framed headboard and stunning cabinetry speak to the intricate craftsmanship and signature Newmar quality found throughout the coach. All-new bedclothes add style and comfort, and an optional king-size bed will ensure that you sleep easy, no matter how many enjoyable miles you've put in.

## ***Features at a glance:***

- Hardwood headboard with vinyl weave inlay
- Plush pillowtop mattress (available in up to king size, as pictured)
- Sony® LED TV and DVD player
- Quilted bedspread with shams, bed scarf & accent pillow







## New – and improved.

Bay Star's bathroom has everything you need to stay comfortable – and in a spectacular new package. An all-new vanity with expanded storage space and a pull-out footstool mean the whole family can freshen up. Attractive lighted sconces, an all-new wall treatment, and detailed woodwork mean the Bay Star's décor and design is flawless all the way.

### ***Features at a glance:***

- Demand Water System with residential flow response
- 6 gal. Gas/electric water heater with electronic ignition
- Power vent and skylight

## BAYSTAR EXTERIOR DÉCOR



Latté Exterior

---

## BAYSTAR INTERIOR DÉCOR

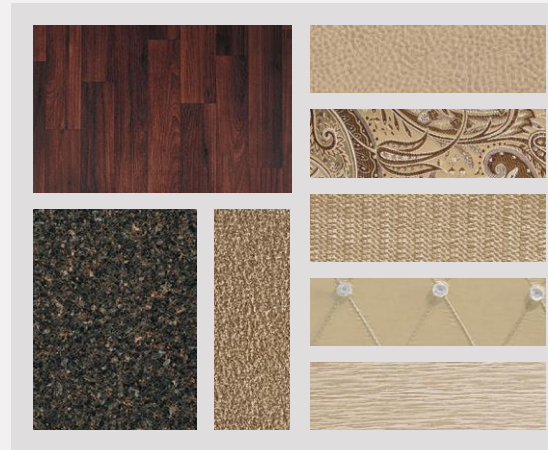

Inca Tan Interior

---

## WOOD OPTIONS



Empire Maple with Glazed Doors



Bisque Maple with Glazed Doors



Hazelnut Exterior

---

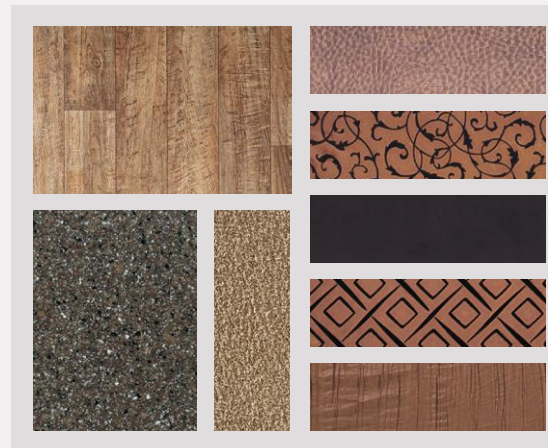

Aztec Bronze Interior

---



Sienna Maple with Glazed Doors

## BAY STAR FLOOR PLANS

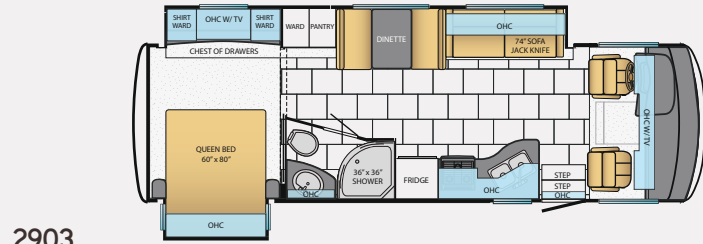

2903

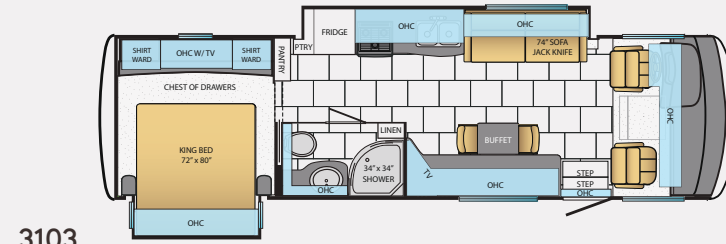

3103

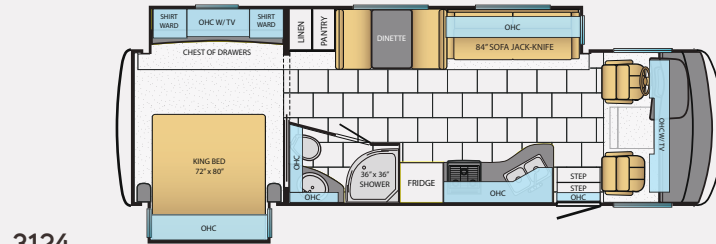

3124

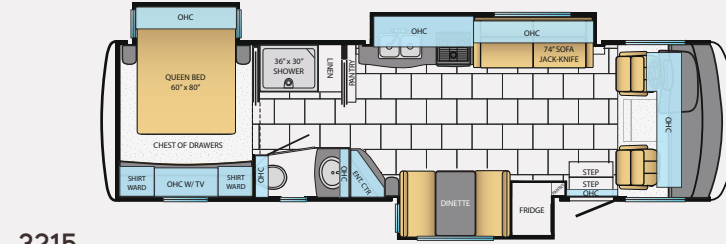

3215

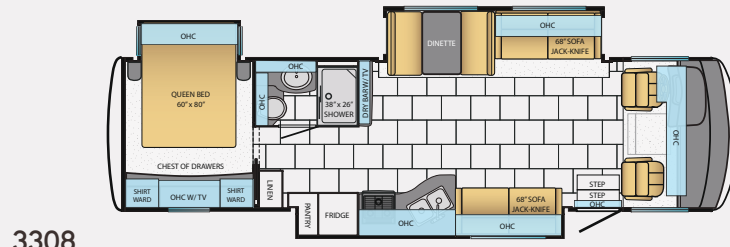

3308

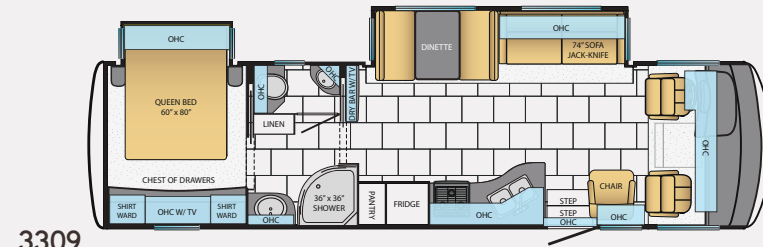

3309

## FLOOR PLAN SPECIFICATIONS

Floor Plan	App. Overall Length	Width	App. Overall Height	Interior Width	Interior Height	Grey Tank	Sewage Tank	Water Tank	Propane Tank	Furnace
2903	29' 10"	101.5"	12' 4"	95.5"	80"	60 gal.	40 gal.	75 gal.	25 gal.	40,000 btu
3103	30' 11"	101.5"	12' 4"	95.5"	80"	60 gal.	40 gal.	75 gal.	25 gal.	40,000 btu
3124	31' 11"	101.5"	12' 4"	95.5"	80"	60 gal.	40 gal.	75 gal.	25 gal.	40,000 btu
3215	32' 11"	101.5"	12' 4"	95.5"	80"	60 gal.	40 gal.	75 gal.	25 gal.	40,000 btu
3308	33' 11"	101.5"	12' 4"	95.5"	80"	60 gal.	40 gal.	75 gal.	25 gal.	46,000 btu
3309	33' 11"	101.5"	12' 4"	95.5"	80"	60 gal.	40 gal.	75 gal.	25 gal.	40,000 btu

# BAY STAR FEATURES & OPTIONS



## Chassis Features

*Built specifically for Newmar with the highest quality in handling, safety, performance, and dependability.*

Ford F-53 20,500 lb.

Hydraulic Leveling Jacks with Automatic Control

Cruise Control

Tilt Steering Wheel

Stainless Steel Wheel Simulators



## Air Conditioning & Heating

*Total Comfort Air Conditioning and Heating systems make climate control simple and effective.*

13.5M Brisk® Central Air Conditioner

Driver/Passenger Overhead Dash Fans

Dash Heater and Air Conditioner

Propane Gas Furnace with Ducted Heat

Propane Leak Detector

### OPTIONS

15.0M Penguin™ Heat Pump Central Air Conditioner

Auxiliary Heater in Bedroom

Extra 13.5 Brisk Air Conditioner, 5.5 Onan Generator, 50 Amp Electrical Service with Energy Management System



## Appliances & Accessories

*All of the amenities of a fine home are integrated in the Newmar design, in both form and capabilities.*

Three-Burner Range with Metal Oven Door & Piezo Ignition\*

Bi-fold Range Cover

Norcold® 8 Cu. Ft. Refrigerator with Black Front Panel

30" Over the Range Microwave Oven\*

6 gal. Gas/Electric Water Heater with Electronic Ignition

10 Bc Fire Extinguisher, Smoke Detector and Carbon Monoxide Detector

### OPTIONS

Frigidaire® 10cf. Refrigerator with Dedicated 1000 Watt Pure Sine Inverter and 2 Extra Batteries

30" Convection Microwave with 3 Burner Cooktop

Sony® Surround Sound System with Sub-Woofer

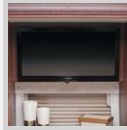

## Audio, Video & Accessories

*Stay entertained on the road and off, with spectacular visual and sound options from industry leaders.*

Sony® LED TV in Living Area and Bedroom (TV sizes vary per floorplan)

Sony® DVD Players in Living Area and Bedroom

AM/FM Dash Radio with CD Player and Auxiliary Jack

Rearview Colored Monitor System with Audio

Winegard Digital TV Antenna

Satellite Prep

### OPTIONS

Sony® 32" LED TV in Front Overhead

Sirius® Satellite Radio Capability (does not include monthly subscription)

Automatic Satellite Dish (does not include receiver)

High-Definition Wiring

Sideview Cameras

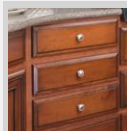

## Cabinets & Furniture

*Amish craftsmanship and elegance in design meld the wood cabinetry and furniture seamlessly with the Newmar interior.*

Empire Maple Mitered Designer Glazed Cabinet Doors

Concealed Hinges on Cabinet Doors

Laminate Kitchen Countertop with Stainless Steel Sink and Two Sink Covers

Laminate Countertop on Bedroom Nightstands and Chests

Laminate Countertop in Bathroom with Acrylic Sink

Residential-Style Full-Extension Ball Bearing Drawer Guides

Pull-out Pantry Shelves\*

Flexsteel® Ultralux Leather Furniture

Lifts on Bed Top

Smooth-Top Mattress

### OPTIONS

Bisque Maple Glazed Cabinets

Sienna Maple Glazed Cabinets

Six way Power Driver's Seat

Combination Desk/Dinette with Buffet Dinette Table with Four Chairs (Two Fixed, Two Folding)

Combination Desk/Dinette with Free Standing Hidden Leaf Table with Four Chairs (Two Fixed, Two Folding)

Free Standing Hidden-Leaf Dinette Table with Four Chairs (Two Fixed, Two Folding)\*

Hide-A-Bed Sofa on Off Door Side

Plush Pillow Top Mattress

Solid Surface Kitchen Base Countertop with Undermounted Sink and Upgraded Faucet

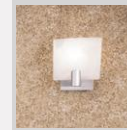

## Electrical Features

*A Newmar coach's electrical and lighting system is designed for maximum reliability, functionality, and style.*

4.0 kW Cummins Onan® Generator with Remote Switch and Automatic Changeover

30 Amp Electrical Service with Flexible Cord

Two 12 Volt House Batteries

Battery Disconnect Switch

110 Volt Exterior Receptacle

12 Volt Auxiliary Receptacle on Dashboard

5 Watt Solar Panel

45 Amp Converter

Daytime Running Lights

Emergency Start Switch

Fluorescent Ceiling Lights Throughout

Lighted Wardrobe

Manually Operated Hold-To-Run Slideout Switch

Recept with Built in USB Charger at Dinette

Cable TV Connection

### OPTIONS

600 Watt Inverter for Living Area and Bedroom TVs

LED Ceiling Lights in Place of Fluorescent Lights

Solar Prep Wire From Roof to Charge House Batteries



## Exterior Features

*The Full-Paint Masterpiece Finish is one of the most beautiful and durable in the industry, with the goal of a perfect finish, every time.*

Full-paint Masterpiece Finish™ With Front Protective Film

---

Convex Exterior Mirrors with Defrost

---

Entrance Door with Automatic Double Step

---

Lighted Exterior Storage Compartments with Cargo Liner

---

Rear Hitch for Towing Car with Two Extra 14-Gauge Wires

---

Assist Handle at Entrance Door

---

Undercoating

---

Mud Flaps

### OPTIONS

Convex Exterior Mirrors with Defrost and Remote Control

---

Rear Ladder

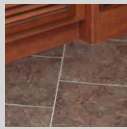

## Interior Features

*Flooring – both tile and carpet – is installed with Newmar’s own in-house process, ensuring the best in quality and longevity, as well as the finest fit.*

Padded Vinyl Ceiling

---

Day/Night Pleated Window Shades and Lambrequins

---

Decorative Wall Art

---

Mini Blinds in Bathroom Window

---

Vinyl Floor in Kitchen, Living Area and Bathroom

---

Carpeting on Slideout floors

---

Interior Assist Handle at Main Entrance Door

---

Shoe Storage Located in Entrance Step Compartment

---

Quilted Bedspread with Shams, Bed Scarf & Accent Pillow

---

Inlaid Six Panel Design Interior Passenger Doors

---

Auto Motion Power Shade at Windshield & Manual Shades at Driver & Passenger Side Windows

---

Dash Panel color Coordinated ABS

---

10 Bc Fire Extinguisher, Smoke Detector and Carbon Monoxide Detector

### OPTIONS

Vinyl tile in Kitchen, Living Area and Bathroom

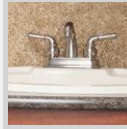

## Plumbing & Bath Features

*The Demand Water System’s residential flow response ensures that the comfort and reliability of home are never far away.*

Demand Water System

---

Sewage Holding-Tank Rinse

---

Water Heater Bypass System

---

Dometic® China Bowl Stool

---

ABS Shower Surround with Shower Door

---

Exterior Shower

---

Monitor Panel

### OPTIONS

110 Volt Heat Pads for Holding Tanks



## Windows, Vents & Awnings

*Experience as much – or as little – of the outdoors as you want in comfort and style.*

One Piece Tinted Windshield

---

Single Pane Tinted Safety-Glass Windows

---

Power Vent in Bathroom and Kitchen

---

Skylight in Bathroom\*

---

Dometic® 8500 Side Awning with Aluminum Weather Shield

---

Dometic® Slideout Covers

### OPTIONS

Double-Pane Tinted Safety Glass Windows

---

Dometic® Weather Pro Side Awning with Aluminum Weather Shield

---

Rear Window in Bedroom

---

Kitchen Window

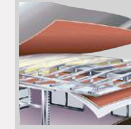

## Construction Features

*From the chassis on up, Newmar coaches are built to be dependable, durable, comfortable, and beautiful.*

BriteTEK™ Roof with Walkable Decking

---

Gelcoated Fiberglass Exterior Sidewalls, Front & Rear Caps

---

Aluminum-Frame Sidewalls & Roof on 16” Centers

---

5/8” Foam Insulation Laminated in Sidewalls & Ceiling

### OPTIONS

Polar Pak R19 Batten Insulation in Roof

\*Check with dealership on floor plan availability and complete listing of features.

## BAY STAR SPORT & BAY STAR CONSTRUCTION



The Bay Star coach features a Ford® F-53 chassis and includes Total Comfort™ Dual In-Roof Ducting Systems and aluminum frame construction.

### CEILING R-VALUE = 16

- a. BriteTEK™ Roof
- b. 9mm Wood Decking
- c. Fiberglass Batten Insulation
- d. Total Comfort™ Ducted A/C
- e. Aluminum Roof Truss
- f. Kraft Paper Vapor Barrier
- g. 5/8" Bead Foam
- h. 3/16" Plywood Ceiling Panel
- i. Padded Vinyl Overlay

### WALLS R-VALUE = 11

- j. 16" On-Center Aluminum Framing with 3 1/2" Header
- k. 3/16" Plywood Interior Wall
- l. 5/8" Bead Foam
- m. Kraft Paper Vapor Barrier
- n. Fiberglass Batten Insulation
- o. 3/16" Plywood Exterior Wall
- p. Composite One-Piece Gelcoat Exterior Sidewall

### FLOOR R-VALUE = 11

- q. Carpet /Tile
- r. Carpet Padding
- s. 5/8" Floor Decking
- t. Fiberglass Batten Insulation
- u. 2"x 3" Wood Framing
- v. Polyethylene Moisture Barrier
- w. Aluminum Ducting

## BAY STAR SPORT SPECIFICATIONS

Floor Plan	Engine HP	Axle Ratio	Fuel Cap.	Wheel Base	Front GAWR*	Rear GAWR*	Tag GAWR*	GVWR*	GCWR*	App. UVW	App. NCC
2702	362	4.88	80 gal.	172"	7,000 lb.	12,000 lb.	0	18,000 lb.	26,000 lb.	15,100 lb.	2,900 lb.
2903	362	4.88	80 gal.	190"	7,000 lb.	12,000 lb.	0	18,000 lb.	26,000 lb.	15,600 lb.	2,400 lb.
3220	362	5.38	80 gal.	200"	7,500 lb.	13,500 lb.	0	20,500 lb.	26,000 lb.	16,300 lb.	4,200 lb.
3306	362	5.38	80 gal.	208"	7,500 lb.	13,500 lb.	0	20,500 lb.	26,000 lb.	15,800 lb.	4,700 lb.

## BAY STAR SPECIFICATIONS

Floor Plan	Engine HP	Axle Ratio	Fuel Cap.	Wheel Base	Front GAWR*	Rear GAWR*	Tag GAWR*	GVWR*	GCWR*	App. UVW	App. NCC
2903	362	5.38	80 gal.	190"	7,500 lb.	13,500 lb.	0	20,500 lb.	26,000 lb.	16,500 lb.	4,000 lb.
3103	362	5.38	80 gal.	200"	7,500 lb.	13,500 lb.	0	20,500 lb.	26,000 lb.	17,100 lb.	3,400 lb.
3124	362	5.38	80 gal.	200"	7,500 lb.	13,500 lb.	0	20,500 lb.	26,000 lb.	17,600 lb.	2,900 lb.
3215	362	5.38	80 gal.	200"	7,500 lb.	13,500 lb.	0	20,500 lb.	26,000 lb.	17,500 lb.	3,000 lb.
3308	362	5.38	80 gal.	208"	7,500 lb.	13,500 lb.	0	20,500 lb.	26,000 lb.	17,800 lb.	2,700 lb.
3309	362	5.38	80 gal.	208"	7,500 lb.	13,500 lb.	0	20,500 lb.	26,000 lb.	17,300 lb.	3,200 lb.

Lengths, heights, widths and dry weights are approximate. Weight will vary based on optional equipment added to the above base weight.

**GAWR:** Gross Axle Weight Rating is the maximum permissible weight for an axle.

**GVWR:** Gross Vehicle Weight Rating is the maximum permissible weight for a fully loaded motor coach.

**GCWR:** Gross Combination Weight Rating is the value specified by the manufacturer of the vehicle as the maximum allowable loaded weight of this motor coach and any towed trailer or towed vehicle.

**UVW:** Unloaded Vehicle Weight is the weight of this motorcoach as built at the factory with full fuel, engine oil and coolants. The UVW does not include cargo, fresh water, propane gas or dealer-installed accessories.

**NCC:** Net Carrying Capacity is the maximum weight of all occupants, including the driver, personal belongings, food, fresh water, waste water, propane gas, tools, tongue weight of towed vehicle, dealer installed accessories, etc., that can be carried by the motor coach.

\*Specifications supplied by the chassis manufacturer.

# Trust.

## The strongest possible foundation for a motor coach.

According to Newmar president Matthew Miller, "Customers say they're loyal to us because they trust us to stand behind our products – from support, parts and service to paying our warranties. It feels good to own a coach that has all of that behind it."

How do we sustain this high level of service? At Newmar, there's a Miller way of doing things. These principles guide us every day. Courtesy. Integrity. And reliability. So when you buy from Newmar, you know that every single person who touches your coach or talks with you has your back. Period.



▲ Mahlon Miller, Newmar founder, and Matthew Miller, Newmar president, lifelong motor coach enthusiasts

# Our Partners.

## Where the finest names in quality and performance are along for the ride.

Newmar strives to offer the best motor coach experience possible, and to that end we partner with the most prestigious names in mobile lifestyle, entertainment, and technology. Depending on the Newmar motor coach you choose, our compliments range from Sony's comprehensive audio, video, communications and information technology to Freightliner and Spartan's superior and dependable chassis designs. Newmar only accepts best-in-class performance from the most trusted names in the business. At Newmar, that's our difference. And our promise.



## 2014 Bay Star & Bay Star Sport

### **NEWMAR EXPRESS LIMITED WARRANTY**

Every Bay Star and Bay Star Sport is backed by Newmar's one-year limited warranty/unlimited miles. Ask your Newmar dealer for details.

### **LIMITED FIVE-YEAR STRUCTURAL WARRANTY**

If any part of your Newmar recreational vehicle superstructure (which is the steel/aluminum structure of the sidewall, roof or frame) fails to perform properly within five years from the date of purchase because of faulty workmanship or material supplied by Newmar, it will be repaired without charge for either parts or labor by Newmar. This structural warranty is available only to the original purchaser and is non-transferable.

*Some features in our literature are optional. Colors and finishes are photographic representations. The actual materials may look different. Prices, specifications and floorplans are subject to change at Newmar's discretion, without prior notice or obligation. Please see your dealer for actual samples and specifications.*



WHEN YOU KNOW THE DIFFERENCE <sup>SM</sup>

NEWMAR CORPORATION  
355 N DELAWARE ST  
PO BOX 30  
NAPPANEE IN 46550-0030  
574-773-7791 Fax 574-773-2895

[www.newmarcorp.com](http://www.newmarcorp.com)

